

CRAFT CENTRAL

Registered Charity (The Clerkenwell Green Association) 281415

# RECRUITING NEW TRUSTEES

*"The Incubator for Creative Expression"*

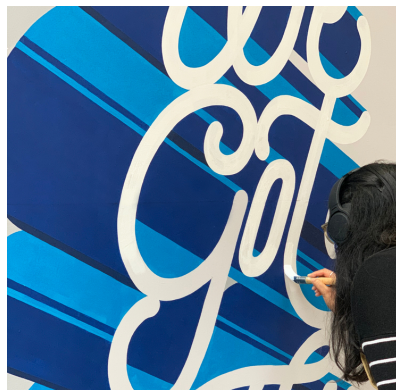

**craft  
central**





CRAFT CENTRAL IS LOOKING FOR NEW TRUSTEES TO JOIN OUR BOARD. CRAFT CENTRAL IS A COMPANY LIMITED BY GUARANTEE AND A REGISTERED CHARITY.



*"Having rented a variety of studios and workshops in our first few years of business, Craft Central is by far the best place we have been based in. Aside from the beautifully kept building and well-managed facilities, the team have encouraged an environment where creatives and small businesses can flourish. Access to facilities such as larger workshops for classes or break our activities, and a wonderful main hall area for larger events and projects is of huge value, but perhaps on a more subtle note, its the culture of the building that the Craft Central team have really got right. There is a genuine sense of community in the building, with artists, technicians and small businesses really finding ways to collaborate or benefit from the cluster of skills and services in the building. It's the ideal environment to nurture young talent within a professional, work context...."*

Jimmy Grimes, Puppetry Director, Designer & Maker, [www.brunskillandgrimes.com](http://www.brunskillandgrimes.com)

## ABOUT US

Clerkenwell Green Association, trading as Craft Central, has been nurturing and supporting craftspeople since 1976. As a registered charity, Craft Central plays a vital role in promoting craftsmanship and has an enviable track record in gaining interest and support for fine craft skills, practices and products, from an ever increasing and wide audience.

Based at The Forge since late 2017, our home is set in a Grade II listed building, which was formerly part of Millwall Iron Works on the Isle of Dogs in London's east end. Having sat empty and neglected for nearly 70 years, we have transformed the space (through our own resources) to create a free-standing, two-storey birch plywood construction, which proudly sits within the vast interior of the 10,000 square feet building. The building is packed with historically important and rare industrial features, patinated exposed brickwork and high ceilings. Housing versatile studio spaces, bathed in natural light, The Forge now offers one of the very best creative spaces in London. This "one-of-a-kind" distinctive building was commended for a New London Award in 2018



We now offer sixty-seven individual studios, fourteen co-working desks, a teaching room, a meeting room, and a 1,000 square feet gallery space, the use of which is free to our studio holders. We provide many resources for creative enterprises and individuals including workshops and classes, plus a programme of events held in our gallery space.

Craft Central is home to a vibrant mix of individuals and practices, ranging from jewellery, illustration, graphic design, animation, photography, millinery, leathercraft, fashion design, video editing, architecture, music composition, fabric design, Saori weaving, embroidery, painting, glass making, sculpture, dressmaking, lettering, perfumery, swimwear, sign-painting, digital art and bespoke floristry. The historical setting, great energy and most of all a group of positive-minded creative people from a range of cultural backgrounds make up the unique community at Craft Central, who benefit from a clean, secure, inspiring and collaborative environment.

Our creative community exhibits and sells fine craft products at our events, and promotes their work on our website, whilst our network of designer-makers enables craftspeople to link with colleagues in the wider craft and creative community, locally, across London, and nationwide. We collaborate with a range of makers events, include markets, open studios and other festivals.

We have been warmly embraced by the local community on the Isle of Dogs, who are pleased to have a new creative and business resource in a part of London often overlooked, being predominantly residential with few amenities close by. Many of our studio holders are local residents (57%) and local people attend our events and workshops.

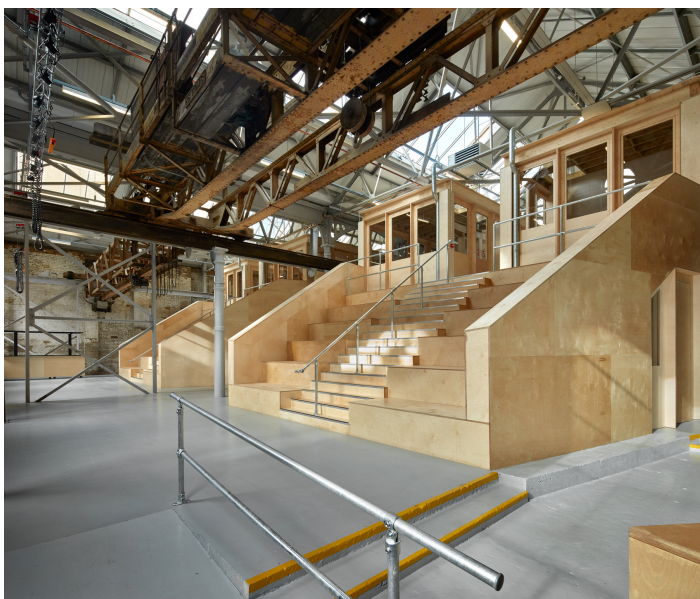

## THE BOARD OF TRUSTEES

The Board of Trustees are critical in setting and overseeing Craft Central's mission, and work with the staff team to lead on and enact the vision for the organisation's future. You don't have to have previous experience as a Board member or Trustee, and not all our Trustees are from an arts or culture background. What we do want are diverse, enthusiastic and committed applicants who believe in the fundamental value of crafts and culture, and who are able to apply their particular skills and life experience to this dynamic organisation, with its broad business model that enables us to support contemporary craft in the UK.



We need our Board of Trustees to be representative of our locality, the crafts professionals we work with, and the audiences we seek to engage. We therefore strongly encourage applications from people who identify as Black, Asian or minority ethnic, young, disabled, LGBTQI+, working-class, or living or working in areas of socioeconomic deprivation.

## THE BOARD

The Board has a capacity for between 7 and 15 members. All members of the Board serve in an individual capacity. They have a duty to support the work of Craft Central as a whole, rather than to act as representatives of a particular interest group. All members are unpaid, non-executive Directors of the Limited Company, Craft Central Ltd. Though these positions are voluntary, travel expenses may be reimbursed for travel outside London.

Craft Central is also a registered charity, so Board members are also Trustees and subject to charity law. The Board is supported by a small professional staff team



*"This opportunity has helped me to focus my career. The commercial success with sole clients at Creative8 has made me realise that I am heading in the right direction with my work and I am currently in the process of putting together a comprehensive marketing campaign to sell my work through galleries and studios."*  
Kevin J Birk (Beneficiary of Creative8)





# THE ROLE AND DUTIES OF THE BOARD

The role of the Board is to provide leadership, continuity of purpose and accountability. The primary duty of Trustees is to act with honesty and good faith in the best interests of the organisation. The Board's duties also include:

- agreeing policy
- setting budgets
- employing and supporting staff
- advocacy and fundraising
- monitoring performance against aims and objectives
- financial, legal and charitable responsibilities

## THE TYPE OF PEOPLE WE ARE LOOKING FOR

People who are enthusiastic about and committed to contemporary art, and who are sympathetic to the needs of craft makers in the UK. We are also seeking Trustees who will add to and complement the skills and experience of other Board members.

## SKILLS AND EXPERIENCE NEEDED

The Board is looking to expand our group of Trustees as we move into our next phase of development, and are particularly interested in recruiting candidates with the following profile, skills or experience:

- Finance or accountancy
- Marketing and Communication
- Fundraising and income generation
- Entrepreneurship
- Buildings and their management
- Business Strategy



*"I am a digital embroidery artist and textiles business owner. In August 2020 I got my first office in Craft Central after working out of my bedroom for 3 years. The incredible office team has provided me with a warm welcome and a comfortable environment to work in. It's a building where many take pride in their craft and know what hard work is. Since I have worked here, the strength in community and support between small businesses and creatives have integrated into my work. We positively share skill and knowledge to support each other when needed - through a pandemic this feels extremely sentimental. I studied fashion textiles throughout my GCSEs, A-Levels and University studies. I have worked as a tailor, freelance embroiderer and many other roles in retail/fashion for the past 10+ years. I finally feel like I found a space where I can grow and stay focused. In December I will be moving into a bigger space in the building. I look forward to creating more art here."*

Sarangua (local Island resident & studio holder)

[www.sarangua.co.uk](http://www.sarangua.co.uk)



# OUR BOARD MEMBERS MUST

- have credibility and standing within their own community or profession
- act as an advocate for Craft Central
- have the ability to operate as an effective Board member at formal meetings and to discuss, listen to, evaluate and have respect for different views
- be willing and able to make time to attend quarterly Board meetings
- be prepared to offer advice and expertise in their specialist areas
- be willing to participate in additional meetings, events and interviews from time to time
- attempt to remain aware of developments in the fields relevant to the organisation
- be loyal to Board decisions and maintain confidentiality
- serve the organisation as a whole rather than a particular interest group within it
- support senior staff
- avoid conflict of interest in relation to any matters of personal interest

## APPOINTMENT PROCEDURE AND TENURE

This is an open call recruitment process. Applications received will be reviewed against the criteria listed in the role description and shortlisted for interview. All applications are treated as confidential and the recruitment process is carried out in line with equal opportunities principles. The normal term of office for Board members is three years, but Board members may be appointed for a further term if they wish and if the remainder of the Board unanimously approve.

Despite the challenges we have faced we have high occupancy in our studios and have built a flourishing community of creative practices who often collaborate and embark on projects together. We offer craftspeople and creatives a stable, consistent environment in which to work and grow.



*"Since moving into Craft Central I've bumped into lots of different types of creatives. I am an animator and projection artist, my studio is opposite a team of glass blowers, and I've made friends with hat makers, puppeteers and photographers. The common areas here offer a daily chance to get involved in conversation and surround yourself in different perspectives and opinions. For me there are some collaboration opportunities as well... so we feed off each other basically."*

Ben Sheppee (local Island resident & studio holder)  
Graphic Fine Art  
[bensheppee.com](http://bensheppee.com)





## OUR CURRENT TRUSTEES

Ellie Botti: Skills Trainer and Mentor in the Creative, Cultural and Libraries sectors

Valerie Emblen: International Development specialist and local resident.

Veronika Harris: Independent Consultant, Coach & Assessor.

Sandy Mitchell: Partner at law firm VWC, specialising in a range of property matters.

## HOW TO APPLY

To apply, please email Peter Cload, Company Secretary via [peter.cload@craftcentral.org.uk](mailto:peter.cload@craftcentral.org.uk) with your CV and a covering letter. Please detail your particular skills and experiences; an outline of your reasons for wanting to become a Trustee of Craft Central; how you meet the skills and experience we're looking for; and how you would act as an advocate for Craft Central and the charity's interests. Please mark in the subject box "Trustee Recruitment".

We invite applications by 12 noon Tuesday 20th July 2021. Applications received after this time will not be considered. If you would like to know more about this opportunity, please contact Peter with the subject line 'Trustee application query' in advance of the application deadline.

Shortlisted prospective Trustees will be invited to interview with a small group of Trustees and the Director in September, with a view to taking up a position from October 2021.